

HANECO LED DOWNLIGHT INSTALLATION GUIDE

VIVA^{SEN}

Thanks for choosing our **VIVA^{SEN}** Downlight products.
We strongly recommend that you read this manual carefully before installation.

WARNING

- Installation must be carried out by a licenced electrician and in accordance with these instructions and relevant Australian standards and local regulations.
- Do not install any luminaire near any heat source.
- Before the installation make sure you have turned OFF the electricity supply.
- Ensure the product is connected to a 220-240V AC 50/60Hz power supply.
- If the external flexible cable or cord of this luminaire is damaged, it shall be exclusively replaced by the manufacturer or by a service agent or licenced electrician in order to avoid hazard.
- Non-user replaceable light source.
- The lens cover of the luminaire is secured by glue, unremovable.
- The warranty is void if product is not installed according to the instructions.
- Risk of overheating of fire if the clearance distances are compromised.

Clearance Guide

This range of Haneco Lighting LED products have been tested to AS/NZS60598.2.2:2016 standards and are approved to the luminaire will not exceed 90°C when side abutted or covered with ceiling insulation.

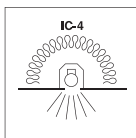

IC-4

Building insulation used to abut and cover the luminaire must meet the following requirements:

- Be of a type that can maintain its dimensions and structural integrity when exposed to the maximum surface temperatures of the class of luminaire, being 90°C and must withstand a 30s needle flame test carried out in accordance with AS/NZS 60695.11.5 with the flame applied to all surfaces of the sample.
- [New Zealand Only] Loose fill insulation as defined in NZS4246 is not permitted to abut or cover this luminaire.

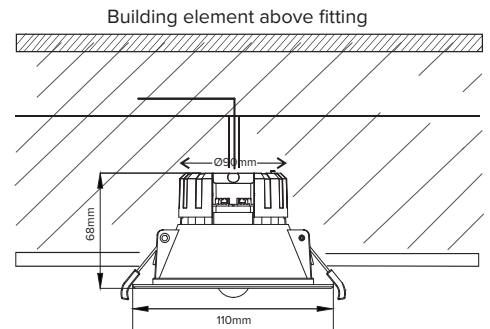

INFO & WARNING	
The minimum clearance distance from the top of the luminaire to any normally flammable building element (mm)	0mm
The minimum clearance distance from the top of the luminaire to any building insulation (mm)	0mm
The minimum clearance distance from the side of the luminaire to any normally flammable building element (mm) ...	0mm
The minimum clearance distance from the side of the luminaire to any normally building insulation (mm)	0mm

Product Specifications

Product Code	Input	Cutout	CRI	Dimming Method	IC Rating	IP Rating	Operating Temp	Maxi Ceiling Thickness
VIVA-SEN	220- 240Vac, 50/60Hz	Ø90mm	>80	Non-Dimmable	IC-4	IP20	-10°C - 45°C	15mm

Installation Instructions

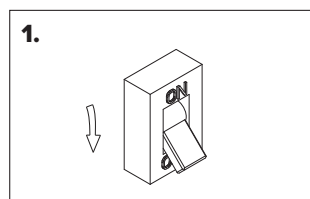

Switch OFF the power.

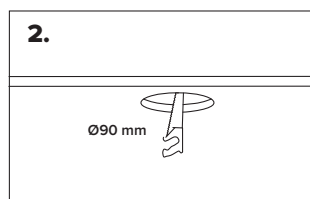

Cut an appropriately sized hole in the ceiling that suits your needs.

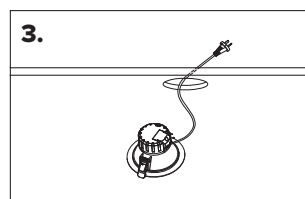

Insert cables through the cut-out into the ceiling cavity and plug into a pre-wired socket outlet inside the ceiling.

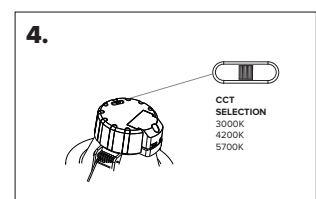

Select the desired CCT using the switch and attach the fascia trim/ trim adapter (optional) with your preferred colour finish.

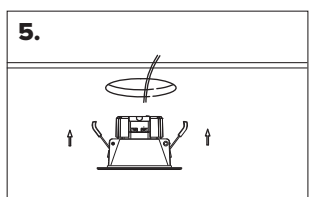

Fold mounting clips up to the sides of the luminaire and insert luminaire through the cut-out.

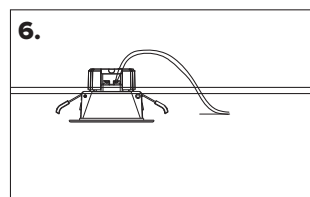

Installing the luminaire in the ceiling.

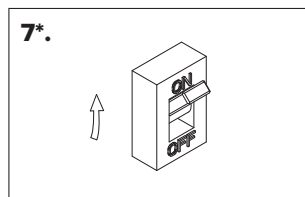

Switch ON power.

*When first connected to mains power, the light fixture will illuminate for 15 seconds and then turn off, which is normal. To activate the light, place it in an environment with 8-20 Lux.

Version Updated on:
16/04/2025

HANECO LED DOWNLIGHT INSTALLATION GUIDE

VIVA^{SEN}

Thanks for choosing our **VIVA^{SEN}** Downlight products.
We strongly recommend that you read this manual carefully before installation.

Sensor Information

Sensor Type	Detection Angle	Detection Radius	Daylight Threshold	Hold Time
PIR	360°	3m	8-20 lux	30±5s

Sensor Setting

Sensor detection range:

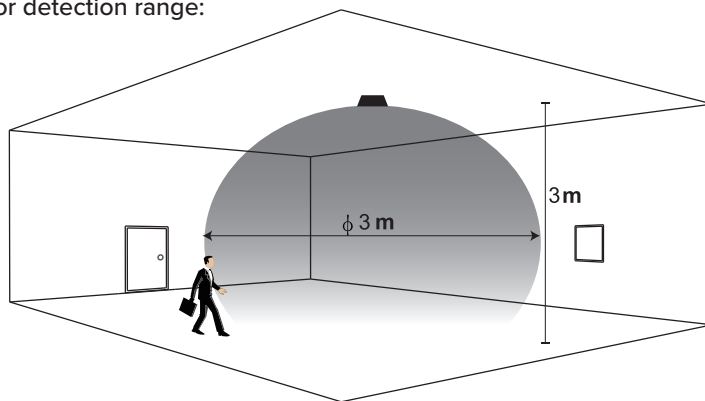

When the VIVA-SEN is powered on for the first time, the downlight will activate for 15 seconds before switching to its normal operating mode.

The built-in daylight threshold function enables the downlight to operate only when ambient light levels are below 8–20 lux and motion is detected by the PIR sensor. The light remains on for up to 30 ±5 seconds and will reset if additional motion is detected during this time.

Version Updated on:
16/04/2025